

SPECIFICATIONS

FREQUENCY BAND Rx: 10.70 - 12.75 GHz
Tx: 13.75 - 14.50 GHz

INSERTION LOSS Rx: 0.50 dB
Tx: 0.35 dB

VSWR Rx: 1.25:1 MAX
Tx: 1.25:1 MAX

ISOLATION Tx/Rx: 85 dB MIN.
Rx/Tx: 70 dB MIN.
Rx/Rx: 35 dB MIN.
Tx/Tx: 35 dB MIN.

CROSSPOL : 35 dB MIN.

POWER HANDLING : 2 kW CW
(1 kW PER Tx PORT)

PRESSURIZATION: SEALED TO 5 PSIG

FINISH

COMMON PORT: CHROMATE CONVERSION COATED PER MIL-DTL-5541F, TYPE II, CLASS 1A
Rx & Tx PORTS: DU CHROME 154-L
EXTERIOR: WHITE PAINT, COLOR No 17875 PER FED-STD-595

REVISIONS

REV	DESCRIPTION	EFFECTIVE DATE	APPROVED BY
C	SEE DR No 10109	04-19-11	M.L.
D	SEE CN No 12021	2015-09-04	J.Mitchell

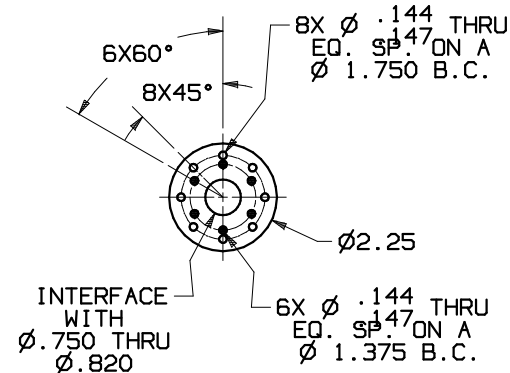
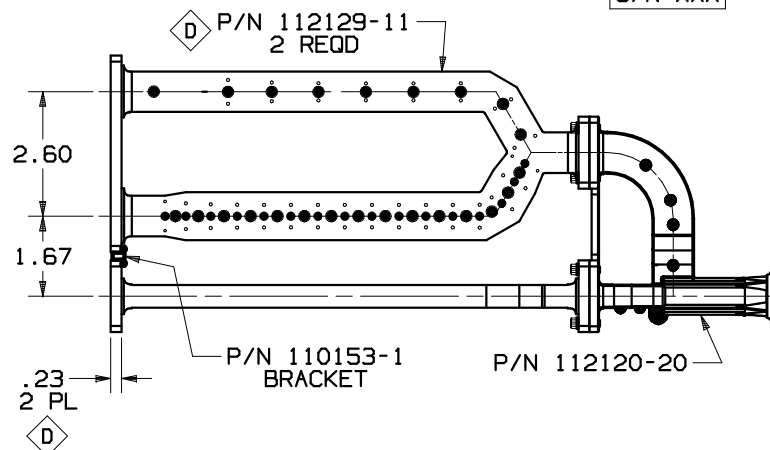
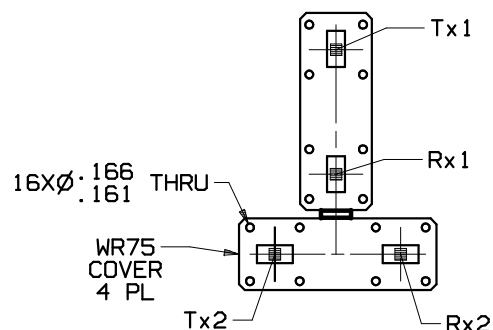
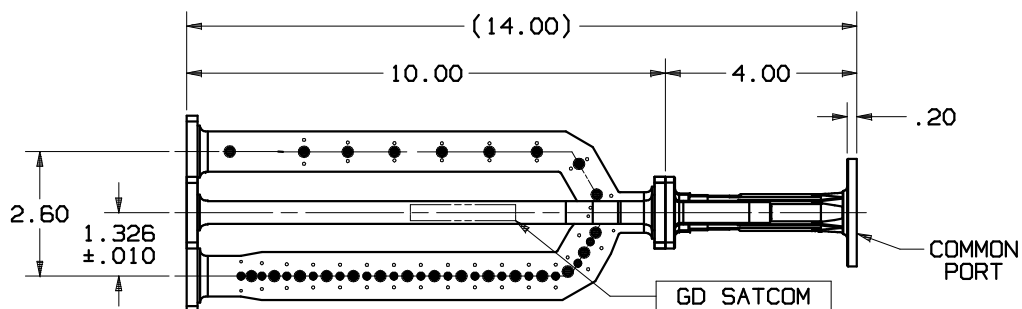

NOTES: UNLESS OTHERWISE SPECIFIED.

UNLESS OTHERWISE SPECIFIED		APPROVALS		DATE		GENERAL DYNAMICS PROPRIETARY			
INTERPRET DIMENSIONING & TOLERANCING PER ANSI Y14.5M-1982. DIMENSIONS ARE IN INCHES. DIMENSIONS SHOWN IN () ARE FOR REFERENCE ONLY. TOLERANCES ARE: SURFACE - TOLERANCES - 32 ✓ .XX ±.01 .XXX ±.002 .XXXX ±.0010 ANGLES ±0°30'		DRAWN: L. TOVALIN		07-21-99		GENERAL DYNAMICS SATCOM Technologies 3111 Fujita St., Torrance, CA 90505, (310) 539-6704			
		CHECKED: H. SPEILEDER		07-21-99					
		RF ENGR:							
		ENGRG:							
MATERIAL:		MFGG:				<div>4-PORT, Ku-BAND WR75</div> <div>SIZEFSCM No.DWG No.112132-1REV D</div> <div>SCALE: 1:2SHEET 1</div>			
		EAR CONTROLLED: Export or re-export subject to 15 CFR 700-799.							